

2000 Ford Mustang V6-3.8L VIN 4
Vehicle > Technical Service Bulletins

HOOD - DIFFICULT TO CLOSE

Article No.

00-21-2

10/16/00

HOOD-HOOD REQUIRES EXCESSIVE EFFORT TO CLOSE-SERVICE TIPS

FORD:

1994-2000 MUSTANG

ISSUE

Some vehicles may exhibit a hood that is hard to close. This may be caused by a hood latch support bracket that is improperly adjusted.

ACTION

Adjust the hood latch support bracket. Refer to the following Service Procedure for details.

SERVICE PROCEDURE

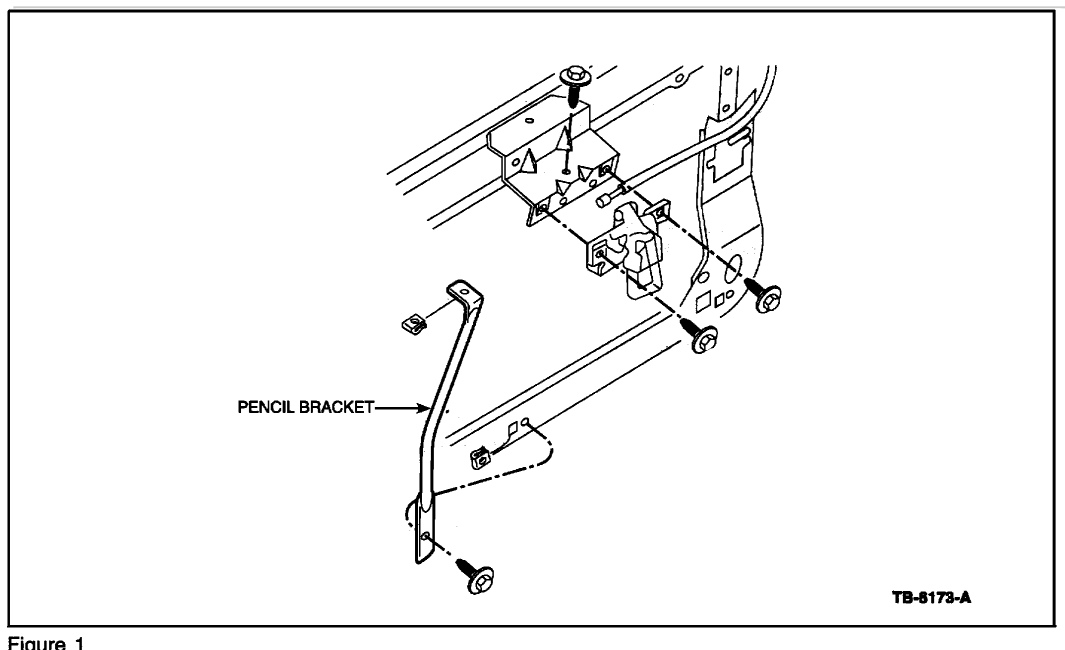
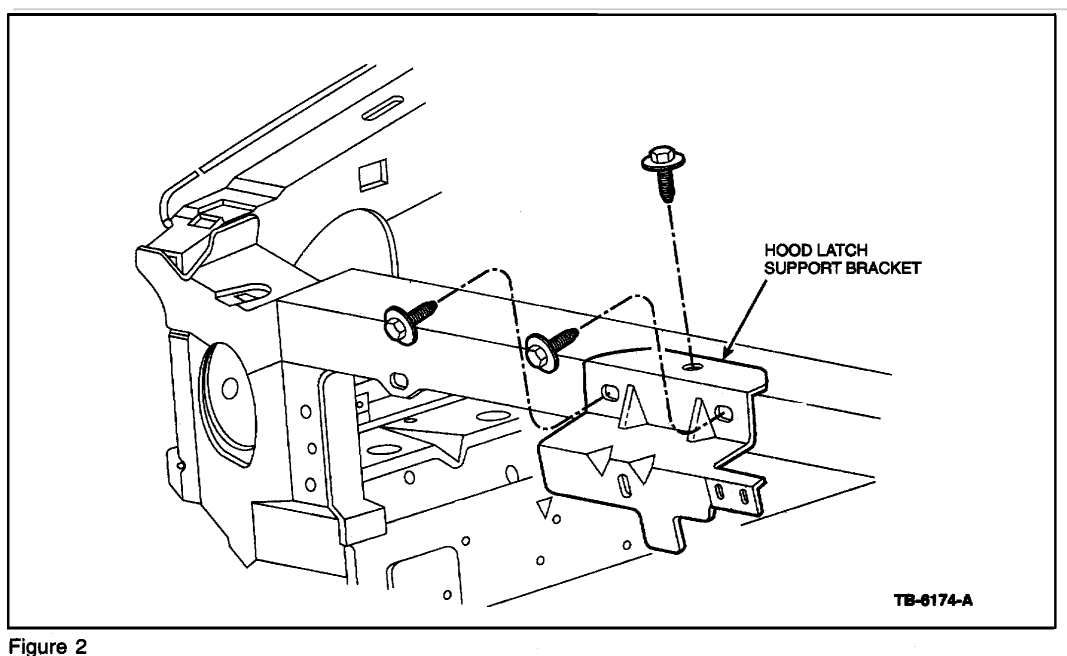

Figure 1

1. Loosen the bolt that attaches the pencil bracket to the bottom of the radiator support (Figure 1).
2. Check to see if the hood latch is interfering with the striker (on inside of hood).
 - a. Gently push hood down after engaging secondary latch and see if the hood is forced sideways in either

direction.

b. Inspect the hood latch to see if paint has been chipped off of either corner. This may help to determine if the hood latch is misadjusted.



3. If there is interference between the hood latch and striker, loosen the three (3) fasteners in the hood latch support bracket that attaches it to the radiator support (one on the top side and two on the forward side) (Figure 2).

4. Move the hood latch support bracket approximately 2mm in the opposite direction of the interference and tighten the top fastener.

5. Perform Step 2 to see if the interference condition has been eliminated; if not, repeat Step 4 until the hood latch freely engages the striker.

6. Secure all three (3) fasteners holding the hood latch support bracket to the radiator support to 12 Nm (9 lb-ft) (Figure 2).

7. Place a pair of channel lock pliers on the front side of the hood latch support bracket and force upward until the bracket is bent approximately 4 degrees (bend bottom of bracket forward). Do this by bending the bracket on both sides of the latch.

8. Check the hood closing effort by raising the hood 25 cm (10") and close to ensure that condition has been eliminated. If a hood closing effort still exists, repeat Step 7 until it has been eliminated.

9. Secure the fastener that attaches the pencil bracket to the bottom of the radiator support to 12 Nm (9 lb-ft) (Figure 1).

OTHER APPLICABLE ARTICLES: NONE

WARRANTY STATUS: Eligible Under The Provisions Of Bumper To Bumper Warranty Coverage

OPERATION	DESCRIPTION	TIME
002102A	Adjust Hood Latch Support Bracket	0.3 Hrs.

OPERATION, DESCRIPTION

BASIC PART NO.
16700

CONDITION CODE
07

DEALER CODING

OASIS CODES: 111000,112000