

2015+ Mustang Hood Scoop

Installation Instructions

P/N: 421858 • 421859 • 421860 • 421861
421862 • 421863 • 421864 • 421865
421866 • 421867 • 421868



2015+ Mustang Hood Scoop

Installation Instructions

P/N: 421858 (R1315-16630XX) - Primed
421859 (R1315-16630CY) - Competition Orange
421860 (R1315-16630H3) - Triple Yellow
421861 (R1315-16630HN) - Guard Green
421862 (R1315-16630J4) - Deep Impact Blue
421863 (R1315-16630J7) - Magnetic
421864 (R1315-16630PQ) - Race Red
421865 (R1315-16630RR) - Ruby Red
421866 (R1315-16630UA) - Black
421867 (R1315-16630UX) - Ingot Silver
421868 (R1315-16630YZ) - Oxford White

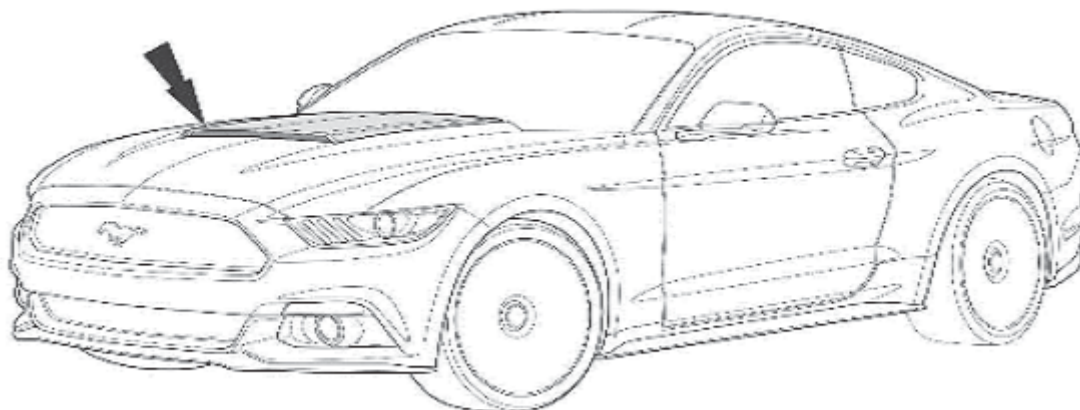

Application: 2015+ Ford Mustang

Important Note:

Before installing your ROUSH Performance Product, please read the installation manual and verify that all items are present. If you are missing hardware or have any questions, please contact ROUSH Performance at 1-800-59-ROUSH.

TABLE OF CONTENTS

Packing List for 2015+ Mustang Hood Scoop2
 Equipment and Supplies Required.....3
 Limit of Liability Statement.....3
 Safety Precautions3
 Work Safely!3
 Hood Scoop Graphic Preparation (Optional)4
 Hood Scoop Installation.....4

PACKING LIST FOR 2015 MUSTANG HOOD SCOOP

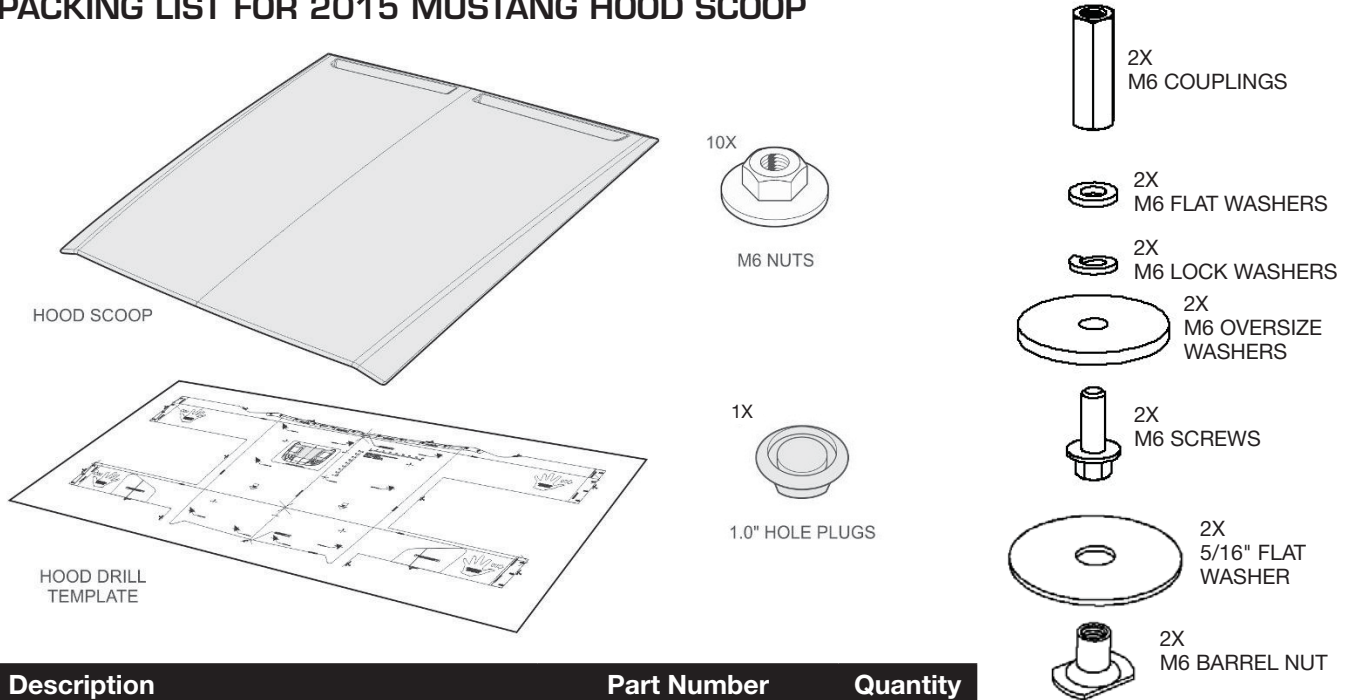

Description	Part Number	Quantity
Hood Scoop Kit	R1315-16630	1
Hood Scoop	1315-16630	1
Hood Scoop Hardware Kit	1315-16630HWK	1
Drill Template	1315-HDSCPTMPL	1
Decal – Hood Scoop Inlet	1315-16630FRT	1
Decal – Rear Extractor LH	1315-16630RRLH	1
Decal – Rear Extractor RH	1315-16630RRRH	1
M6 Nuts	W704521	10
1.0" Rubber Hole Plugs	BPF-SI-413	1
M6 Barrel Nut	90594A350	2
5/16" Oversize Flat Washer	91090A119	2
M6 x 1.0 x 16 Hex Flange w/Black Finish	W500013	2
1/4" Oversize Flat Washer	92140A114	2
M6 Flat Washer Zinc-Plated	91455A120	2
M6 Split Lock Washer Zinc-Plated	91202A234	2
M6 x 1.0 x 30 Hex Coupling Nut	93355A954	2
Go to Website Instructions	1315-P1INST	1

EQUIPMENT AND SUPPLIES REQUIRED

- Isopropyl Alcohol Packets or 50/50 Alcohol/Water Solution
- Drop Cloth
- Scissors
- Masking Tape
- Deburr Tool
- Drill
- Drill Bits: 1/8", 5/16", 7/16", 1.0" Hole Saw
- Corrosion Inhibitor (Motorcraft PMP-19500-6000 Clear Topcoat recommended)
- 1/4" Drive Ratchet
- 1/4" Extension
- 1/4" 10 mm Socket
- 1/4" Torque Wrench
- Round File
- Rubber Roller
- 13 mm Wrench
- 8 mm Socket
- Center Punch

If you are missing any items, please call us toll free at 1-800-59-ROUSH.

LIMIT OF LIABILITY STATEMENT

The information contained in this publication was accurate and in effect at the time the publication was approved for printing and is subject to change without notice or liability. ROUSH Performance Products (RPP) reserves the right to revise the information presented herein or to discontinue the production of parts described at any time.

SAFETY PRECAUTIONS



CAREFULLY READ THE IMPORTANT SAFETY PRECAUTIONS and WARNINGS BEFORE PROCEEDING WITH THE INSTALLATION!

Appropriate disassembly, assembly methods and procedures are essential to ensure the personal safety of the individual performing the kit installation. Improper installation due to the failure to correctly follow these instructions could cause personal injury or death. Read each step of the installation manual carefully before starting the installation.

- Always wear safety glasses for eye protection.
- Place ignition switch in the OFF position.
- Always apply the parking brake when working on a vehicle.
- Block the front and rear tire surface to prevent unexpected vehicle movement.
- If working with a lift, always consult vehicle manual for correct lifting specifications.
- Operate the engine only in well-ventilated areas to avoid exposure to carbon monoxide.
- Do not smoke or use flammable items near or around the fuel system.
- Use chemicals and cleaners in well-ventilated areas.
- Batteries produce explosive gases, which can cause personal injury. Therefore, do not allow flames, sparks or flammable substances to come near the battery.
- Keep hands and any other objects away from the radiator fan blades.
- Keep yourself and your clothing away from moving parts when the engine is running.
- Do not wear loose clothing or jewelry that can get caught in rotating parts or scratch surface finishes.
- Allow the engine, cooling system, brakes and exhaust to cool before working on a vehicle.

WORK SAFELY!

Perform this installation on a good clean level surface for maximum safety with the engine turned off.

PAINTED PART PREPARATION



Unpainted/primed parts purchased from ROUSH require further preparation prior to being painted. Removal of any excess plastic flashing and sanding of the primed parts is required prior to paint application. The primed parts as received should not be painted without further surface preparation.

HOOD SCOOP GRAPHIC PREPARATION (OPTIONAL)

1. Place the hood scoop on a suitable working area.
2. With the scoop facing away from you and the painted surface facing upward, remove the backing from the adhesive side of the rear hood scoop graphic.
3. Position the rear LH graphic in the LH feature of the scoop. Once the graphic is in position, wipe from the center out towards each side to set the graphic into position using a flat-blade tool (credit card). Remove the top carrier from the graphic.

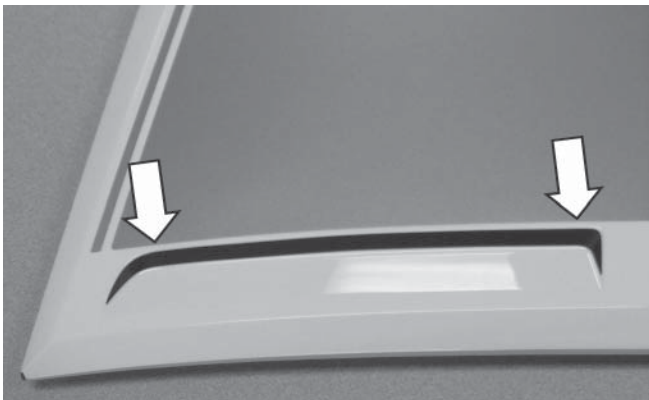

4. Repeat for the rear RH graphic.
5. Rotate the hood scoop upside down, with the front facing you. Use care to not scratch or mar the painted surface.
6. Remove the backing from the adhesive side of the front inlet graphic. Position the front inlet graphic along the edge of the front of the scoop. Wiping from the center out towards each side, set the graphic into position using a flat-blade tool (credit card). Remove the top carrier from the graphic.

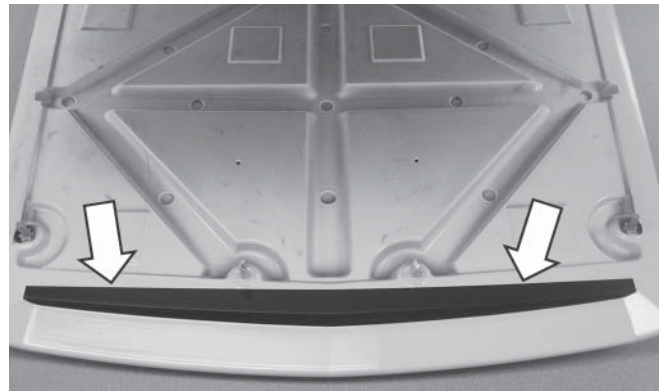

HOOD SCOOP INSTALLATION

1. Make sure the vehicle's sheet metal is clean and dry. The sheet metal should be between 61°-81°F (16°-31°C).
2. Open the hood and remove the inner hood liner by removing the push pins with a proper trim tool. Use caution to not lose the push pin retainers while removing them.
3. Place a large drop cloth in the engine bay underneath the hood. Cover any area directly under the area where the hood is to be drilled.

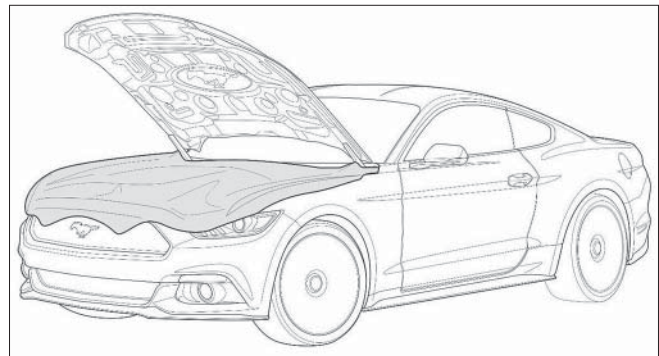

4. Carefully cut out the hood outer drill template. Take extra care in the areas indicated with black arrows. These areas are crucial to the correct alignment of the template.

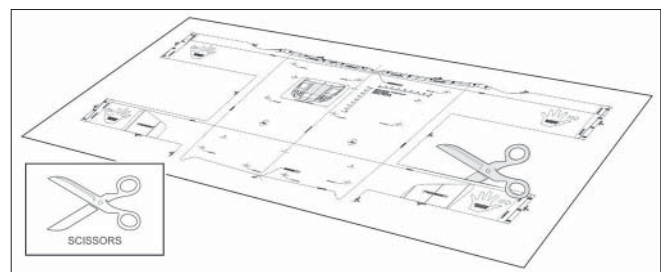

5. Install the hood scoop drill template. With the hood closed, align the template to the hood outer sheet metal as shown. Secure the template to the hood with masking tape.

Attention: Confirm the template is properly centered and aligned before continuing to the next step.

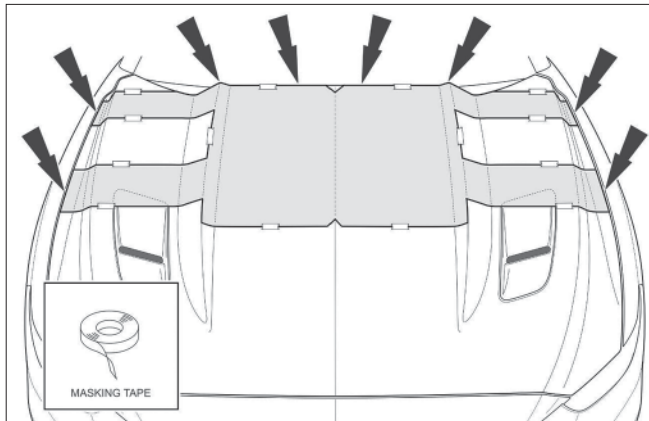

6. Center punch the outer sheet metal of the hood at each of the ten (10) locations indicated on the template. Drill each center punched location with a 1/8" drill bit. Be sure to move the washer nozzles aside when drilling the rear outer corners. At the three (3) rear locations and the two (2) outer front locations, drill straight through both the outer and inner sheet metal. Refer to the circled areas in the illustration below.

CAUTION

Care should be taken in order not to damage any of the vehicle components underneath the hood. Pay close attention to the two (2) rear most outer holes closest to the windshield as the washer jet nozzles are located underneath this area.

Enlarge each hole on the outer sheet metal only to the size indicated on the template. Note that the center hole should be enlarged to 5/16" while the other nine (9) holes should be enlarged to 7/16".

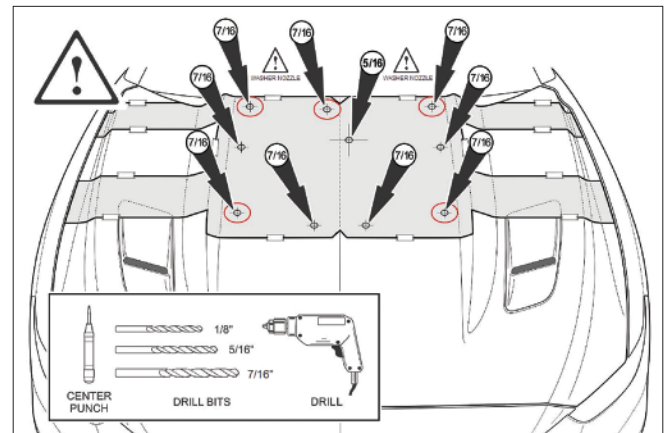

7. Open the hood and locate the five (5) 1/8" holes drilled into the inner sheet metal during Step 6. Enlarge each of the five (5) 1/8" hole locations with a 1.0" hole saw.

CAUTION

Care should be taken not to damage the hood outer sheet metal while drilling the five (5) 1.0" access holes. Pay close attention to the two (2) rear most outer holes closest to the windshield as the washer jet nozzles are located underneath this area.

Deburr and apply corrosion inhibitor to each of the five (5) 1.0" access holes. Allow to dry.

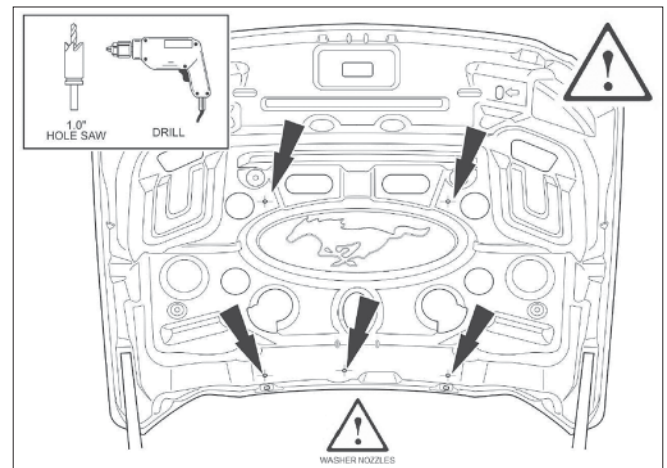

8. With the hood closed, test fit the hood scoop on the hood. Align the ten (10) studs on the hood scoop through the holes drilled in the hood. Secure the hood scoop to the hood with masking tape.

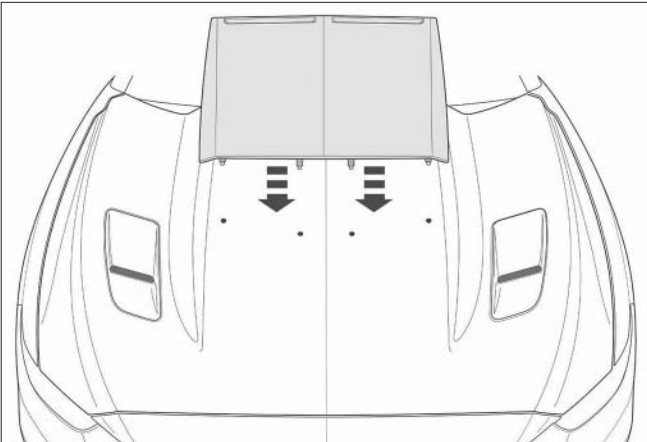

9. Open the hood and inspect each of the ten (10) mounting locations. Confirm the alignment of the hood scoop fasteners with the holes drilled in the outer sheet metal.

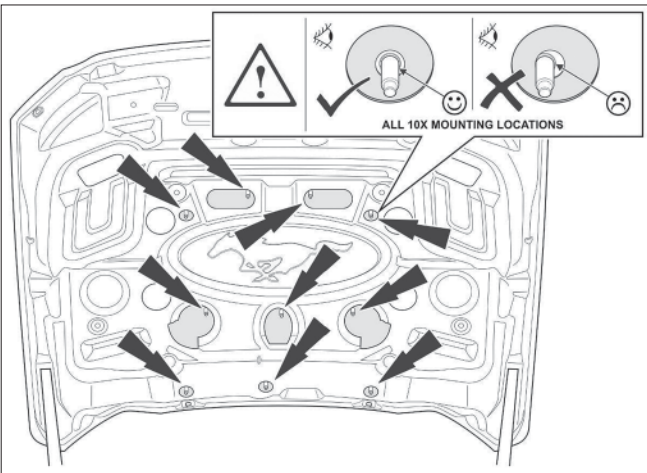

10. If the fasteners and holes are not aligned, remove the hood scoop and use a round file to adjust the holes in the sheet metal accordingly.

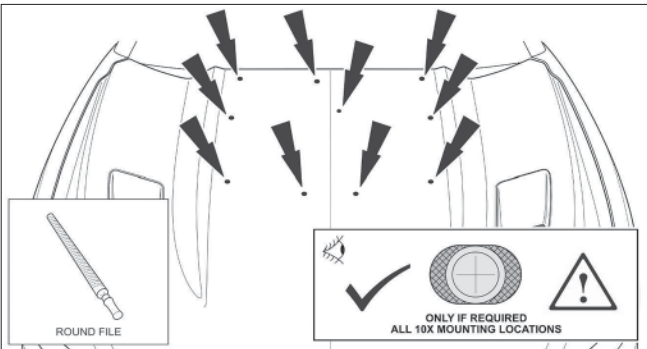

11. Deburr and apply corrosion inhibitor to all of the holes drilled in the outer sheet metal. Allow to dry.

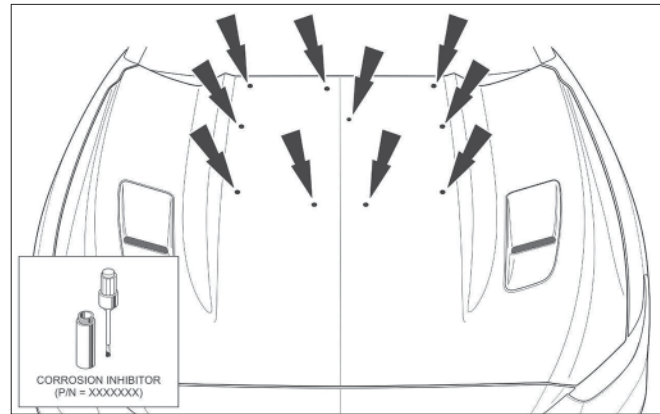

12. Use a 50/50 (alcohol/water) solution to clean the area of the hood where the hood scoop will be installed.

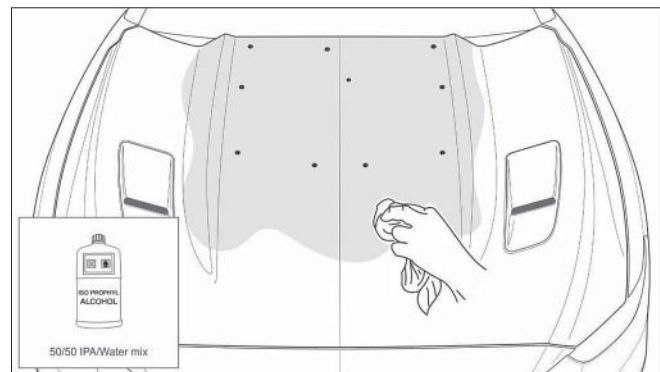

13. Prepare the hood scoop for installation. Peel 2.0" (50.8 mm) of each tape liner and secure it to the top of the hood scoop. Remove the liners from the LH and RH triangular die cuts.

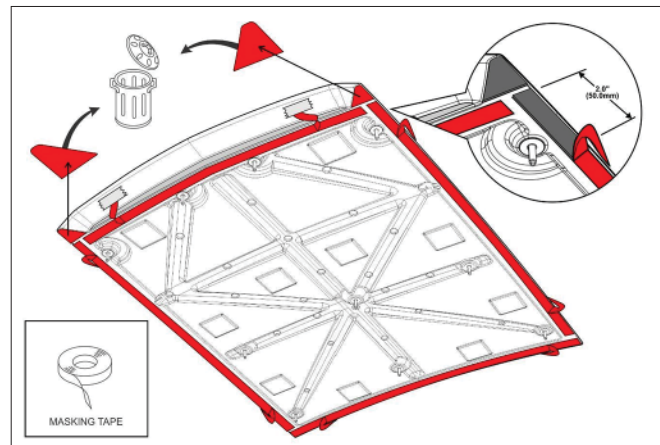

14. Install the hood scoop through the holes and onto the hood sheet metal. Do not allow the exposed double-sided tape to adhere to the sheet metal until you have confirmed the hood scoop is aligned, then push down.
15. Remove all of the tape liners in the directions indicated below.

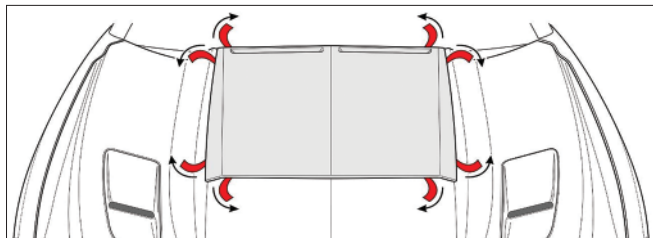

16. Using a rubber roller or the palm of your hand, apply 15 ft-lb of force to the tape area in order 'wet out' the double-sided tape.

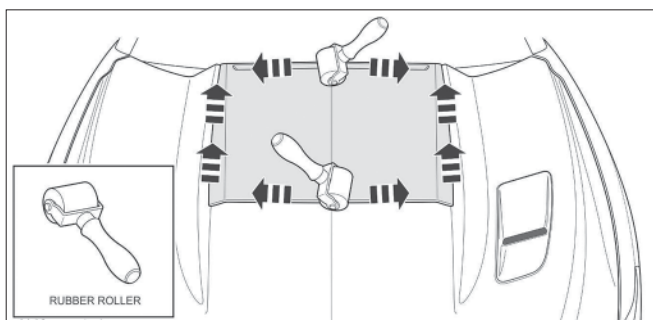

17. Secure the hood scoop to the hood sheet metal. Open the hood and install ten (10) M6 nuts. Hand tighten only, do not use power or pneumatic tools.

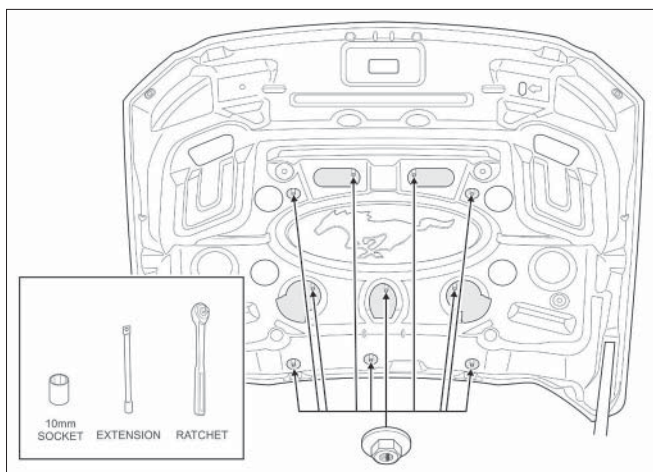

18. Torque all fasteners to 3.5 Nm.

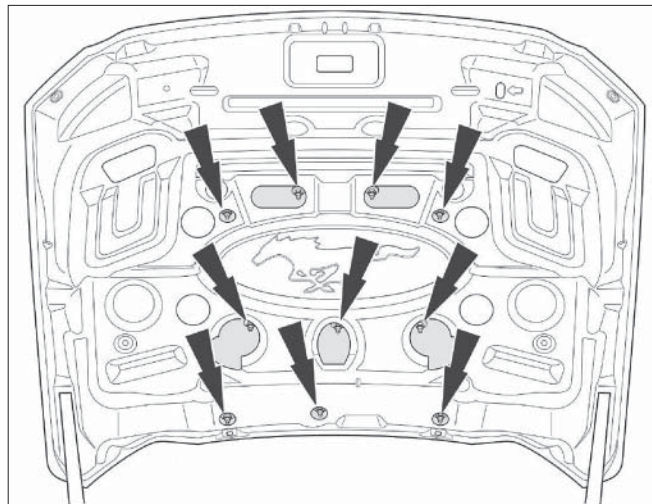

19. Install one (1) rubber hole plug into the access hole shown below that was drilled in Step 7.

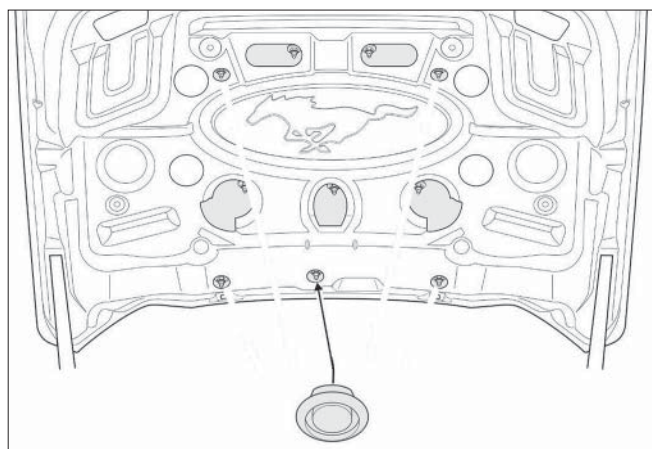

20. Place one (1) large flat washer (P/N: 92140A114) onto (1) M6 screw (P/N: W500013) followed by one (1) M6 lock washer (P/N: 91202A234) then one (1) smaller M6 flat washer (P/N: 91455A120) and finally one (1) M6 hex coupling nut (P/N: 93355A954) and torque the assembly to 10 Nm. Repeat this process with the remaining hardware to create one (1) more coupling assembly.

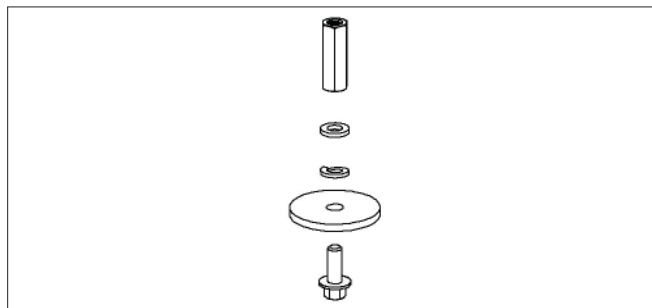

21. Thread one (1) coupling assembly onto each of the studs as shown below. Torque to 3.5 Nm.

NOTE: THE WINDSHIELD SPRAY NOZZLE TUBES ARE LOCATED NEAR THE STUDS.

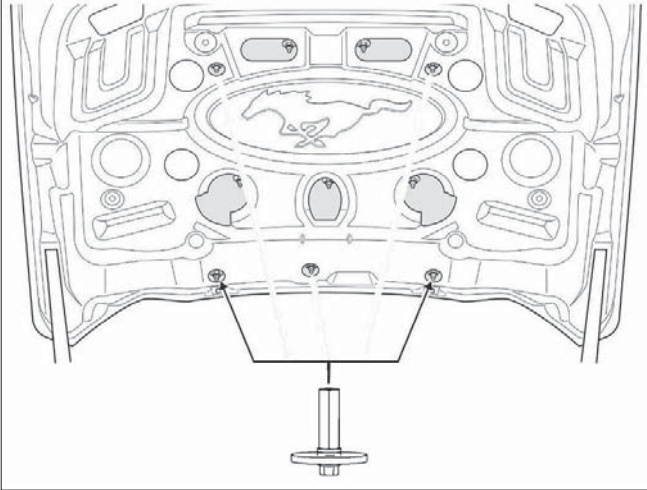

22. Thread one (1) M6 Barrel Nut (P/N: 90594A350) with one (1) 5/16" Oversize Flat Washer (P/N: 91090A119) onto each of the studs as shown below. Torque to 3.5 Nm.

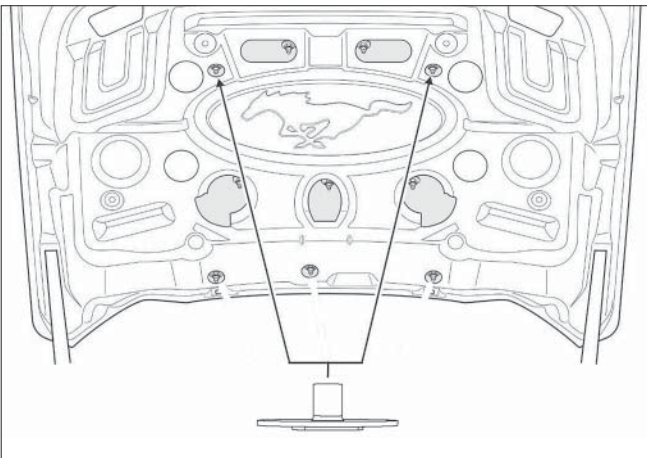

23. Reinstall the hood inner liner using the previously removed push pins.
24. Carefully remove drop cloth, making sure not to spill any of the metal shavings into the engine bay. Vacuum up any stray metal shavings.

Congratulations!!! The installation is complete.